

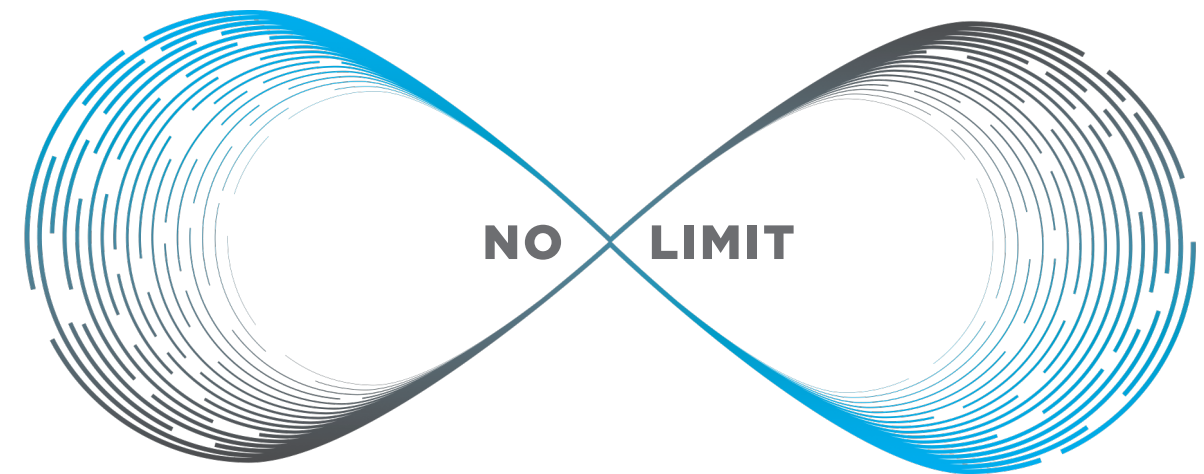

AGGRESSOR

IMMEDIATE LOADING



IMPLANCE
Dental Implant System

AGGRESSOR

Aggressor implant provides unlimited application possibilities.

Aggressor implant offers immediate loading. It does not cause stress in the neck area with its improved aggressive thread design and sharper threads towards the apex.

Aggressor implant body design with increased taper towards its apical, provides high primary stability in the extraction socket and D3-D4 bone type.

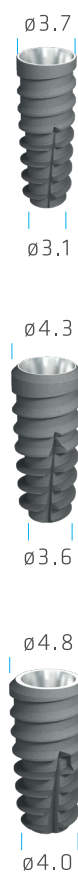

Ø3.7

| Length (mm) | Code |
|-------------|----------|
| 10.0 | BFAR3710 |
| 12.0 | BFAR3712 |
| 14.0 | BFAR3714 |

Ø4.3

| Length (mm) | Code |
|-------------|----------|
| 10.0 | BFAR4310 |
| 12.0 | BFAR4312 |
| 14.0 | BFAR4314 |

Ø4.8

| Length (mm) | Code |
|-------------|----------|
| 10.0 | BFAR4810 |
| 12.0 | BFAR4812 |
| 14.0 | BFAR4814 |

- Aggressive thread design
- Natural root-form
- Sharper threads at the apex
- More contact area with the bone
- Strong primary stability in every bone type
- Immediate implantation and immediate loading protocol

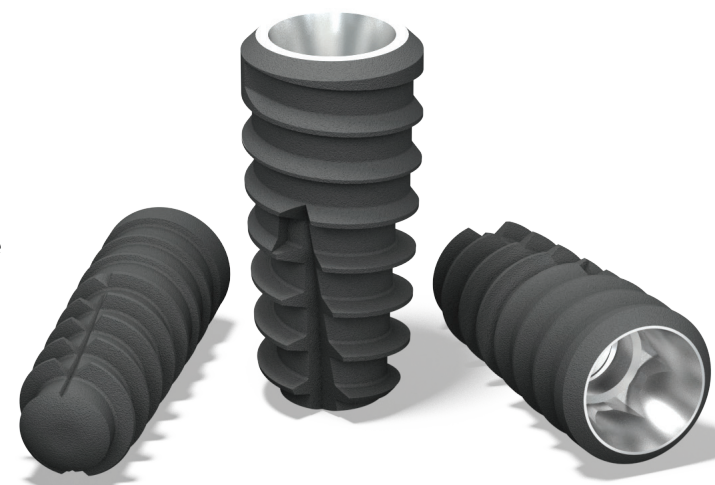

Self-stopper Drills

Self-stopper drills provide great convenience to the users and cancel out the possibility of committing error.

Aggressor implant drills operate at 200-300 rpm, thus preventing necrosis caused by excessive heat. Autogenous bone graft can be collected due to low speed drilling and used for the treatment of the patient.

High primary stability can be achieved with the conical drills designed as per the conical structure of the Implants Aggressor implants.

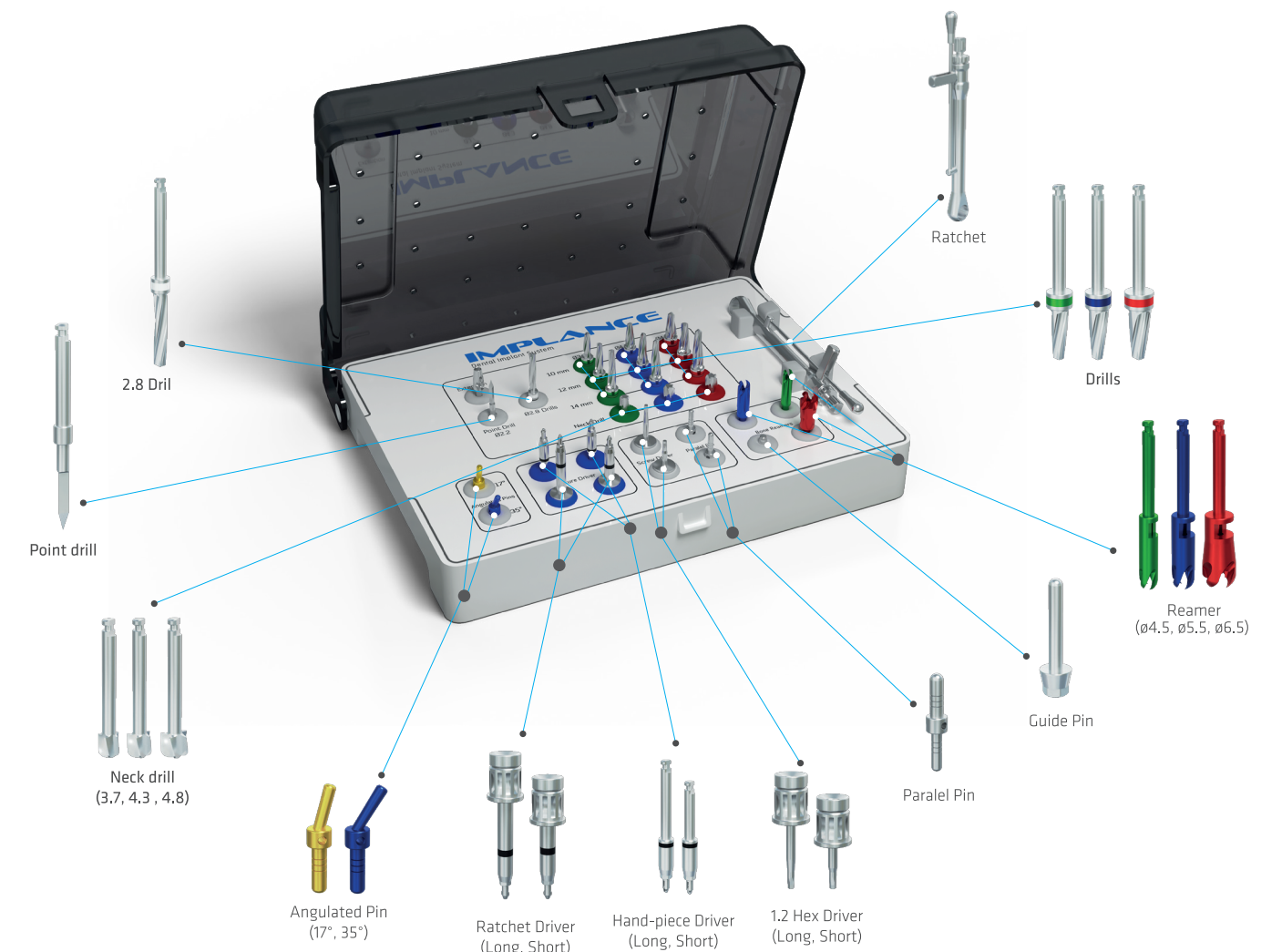

Auxiliary Drills

The ideal exit platform can be created for the abutments by scraping the excess bone in the neck of the implant with the use of Bone Reamer available in three diameters.